



B.S. STANDARD LUGS

Copper Compression Standard Barrel Cable Lugs

Copper Compression Tube Terminals 1.5 – 1000 mm²



● MATERIAL :

COPPER to BS 1977

● COPPER CONDUCTIVITY :

99.25% IACS (International Annealed Copper standard)

● FINISH :

Electro-Tin plated to prevent corrosion and improve conductivity.

● SALIENT FEATURES :

Barrel Entrance Chamfered to facilitate cable insertion smoothly and easily.

Inspection Window to ensure full conductor insertion.

Lugs are fully annealed for secured crimping.

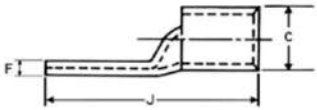
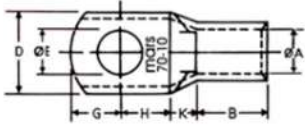

CABLE SIZE (MM ²)	STUD SIZE (MM ²)	DIMENSIONS (MM)										MARS CAT NO.
		ØE	ØA	C	D	F	B	K	H	G	J	
1.5	4	4.2	1.8	3.7	8	1	5	2	5	4	16	M 1.5-4
	5	5.2	1.8	3.7	8	1	5	2	5	4	16	M 1.5-5
	6	6.5	1.8	3.7	10	0.8	5	2	6	5	18	M 1.5-6
2.5	4	4.2	2.4	4.0	8	1	7	2	5	4	18	M 2.5-4
	5	5.2	2.4	4.0	10	0.8	7	2	6	5	20	M 2.5-5
	6	6.5	2.4	4.0	10	0.8	7	2	6	5	20	M 2.5-6
	8	8.2	2.4	4.0	11	0.7	7	2	8.5	6.5	24	M 2.5-8
4	5	5.2	3.1	4.8	10	1	7	2	6	5	20	M 4-5
	6	6.5	3.1	4.8	10	1	7	2	6	5	20	M 4-6
	8	8.4	3.1	4.8	12	0.8	7	2	8.5	5.5	24	M 4-8
6	5	5.2	3.8	5.5	10	1.2	9	3	6	5	23	M 6-5
	6	6.5	3.8	5.5	12	1	9	3	9	6	27	M 6-6
	8	8.4	3.8	5.5	12	1	9	3	9	6	27	M 6-8
	10	10.5	3.8	5.5	16	0.8	9	3	11	9	32	M 6-10
10	5	5.2	4.5	6.2	12	1.2	9	3	7	6	25	M 10-5
	6	6.5	4.5	6.2	12	1.2	9	3	7	6	25	M 10-6
	8	8.4	4.5	6.2	12	1.2	9	3	9	6	27	M 10-8
	10	10.5	4.5	6.2	19	1.8	9	4	10	10	33	M 10-10
	12	13	4.5	6.2	19	1.8	9	4	12	12	37	M 10-12
16	5	5.2	5.4	7.1	12	1.4	12	4	7	7	30	M 16-5
	6	6.5	5.4	7.1	12	1.4	12	4	7	7	30	M 16-6
	8	8.4	5.4	7.1	12	1.4	12	4	9	7	32	M 16-8
	10	10.5	5.4	7.1	19	1.8	12	4	10	10	36	M 16-10
	12	13	5.4	7.1	19	1.8	19	3	12	12	40	M 16-12
25	6	6.5	6.8	8.8	13	2.0	12	4	7	7	30	M 25-6
	8	8.4	6.8	8.8	16	1.6	12	4	11	10	37	M 25-8
	10	10.5	6.8	8.8	16	1.6	12	4	11	10	37	M 25-10
	12	13	6.8	8.8	18	1.4	12	4	13	12	41	M 25-12
35	6	6.5	8.2	10.6	15	2.4	12	5	9	9	35	M 35-6
	8	8.4	8.2	10.6	15	2.4	12	5	9	9	35	M 35-8
	10	10.5	8.2	10.6	18	2.0	12	5	11	10	38	M 35-10
	12	13	8.2	10.6	20	1.8	15	5	13	13	45	M 35-12

50	6	6.5	9.5	12.4	18	2.9	16	6	11	10	43	M 50-6
	8	8.4	9.5	12.4	18	2.9	16	6	11	10	43	M 50-8
	10	10.5	9.5	12.4	18	2.9	16	6	11	10	43	M 50-10
	12	13	9.5	12.4	20	2.5	16	6	13	12	47	M 50-12
70	6	6.5	11.2	14.7	21	3.5	10	7	10	12	50	M 70-6
	8	8.4	11.2	14.7	21	3.5	18	7	13	12	50	M 70-8
	10	10.5	11.2	14.7	21	3.5	18	7	13	12	50	M 70-10
	12	13	11.2	14.7	21	3.5	18	7	13	12	50	M 70-12
	14	15	11.2	14.7	28	2.2	18	7	16	16	57	M 70-14
	16	17	11.2	14.7	28	2.2	18	7	16	16	57	M 70-16
95	8	8.4	13.5	17.4	25	3.9	20	9	13	13	55	M 95-8
	10	10.5	13.5	17.4	25	3.9	20	9	13	13	55	M 95-10
	12	13	13.5	17.4	25	3.9	20	9	13	13	55	M 95-12
	14	15	13.5	17.4	28	3.2	20	9	16	16	61	M 95-14
	16	17	13.5	17.4	28	3.2	20	9	16	16	61	M 95-16
120	8	8.4	15	19.4	28	4.4	22	10	14	14	60	M 120-8
	10	10.5	15	19.4	28	4.4	22	10	14	14	60	M 120-10
	12	13	15	19.4	28	4.4	22	10	14	14	60	M 120-12
	14	15	15	19.4	28	4.4	22	10	16	16	64	M 120-14
	16	17	15	19.4	28	4.4	22	10	16	16	64	M 120-16
150	8	8.4	16.5	21.2	30	4.7	26	11	16	16	69	M 150-8
	10	10.5	16.5	21.2	30	4.7	26	11	16	16	69	M 150-10
	12	13	16.5	21.2	30	4.7	26	11	16	16	69	M 150-12
	14	15	16.5	21.2	30	4.7	26	11	16	16	69	M 150-14
	16	17	16.5	21.2	30	4.7	26	11	16	16	69	M 150-16
	20	21	16.5	21.2	34	4.3	26	11	23	19	79	M 150-20
185	10	10.5	18.5	23.5	34	5.0	32	12	17	17	78	M 185-10
	12	13	18.5	23.5	34	5.0	32	12	17	17	78	M 185-12
	14	15	18.5	23.5	34	5.0	32	12	17	17	78	M 185-14
	16	17	18.5	23.5	34	5.0	32	12	17	17	78	M 185-16
	20	21	18.5	23.5	34	5.0	32	12	17	17	78	M 185-20
240	10	10.5	21	26.5	38	5.5	38	14	20	20	92	M 240-10
	12	13	21	26.5	38	5.5	38	14	20	20	92	M 240-12
	14	15	21	26.5	38	5.5	38	14	20	20	92	M 240-14
	16	17	21	26.5	38	5.5	38	14	20	20	92	M 240-16
	20	21	21	26.5	38	5.5	38	14	20	20	92	M 240-20
300	12	13	23.5	30	43	6.5	42	15	22	22	101	M 300-12
	14	15	23.5	30	43	6.5	42	15	22	22	101	M 300-14
	16	17	23.5	30	43	6.5	42	15	22	22	101	M 300-16
	20	21	23.5	30	43	6.5	42	15	22	22	101	M 300-20
400	12	13	26.8	34.8	50.1	8	44	18	26	26	114	M 400-12
	14	15	26.8	34.8	50.1	8	44	18	26	26	114	M 400-14
	16	17	26.8	34.8	50.1	8	44	18	26	26	114	M 400-16
	20	21	26.8	34.8	50.1	8	44	18	26	26	114	M 400-20
500	16	17	30	39	56	9	48	20	28	28	124	M 500-16
	20	21	30	39	56	9	48	20	28	28	124	M 500-20
550	20	21	31.7	41.4	59.5	9.7	52	20	30	30	132	M 550-20
630	16	17	35	45	65	10	56	22	33	33	144	M 630-16
	20	21	35	45	65	10	56	22	33	33	144	M 630-20
800	-	-	39	50.6	72.9	11.6	78	17	37	38	170	M 800-B
1000	-	-	43	56.2	80.8	13.2	90	20	45	45	200	M 1000-B

Note:

- » Blank terminal palms available from 10 sq mm to 1000 sq mm.
- » Smaller D8 and larger D8 stud hole available on request.
- » Longer Barrel available on request.
- » Bell Mouthed entry available from 10 Sq mm to 400 Sq mm.

Copper Compression Two Hole Cable Lugs

Copper Compression Two Hole Extended Palm Terminals



MATERIAL :

COPPER to BS 1977

COPPER CONDUCTIVITY :

99.25% IACS (International Annealed Copper standard)

FINISH :

Electro-Tin plated to prevent corrosion and improve conductivity.

SALIENT FEATURES :

Barrel Entrance Chamfered to facilitate cable insertion smoothly and easily.

Inspection Window to ensure full conductor insertion.

Lugs are fully annealed for secured crimping.

Internal diameter suit cables defined in BS 6360.

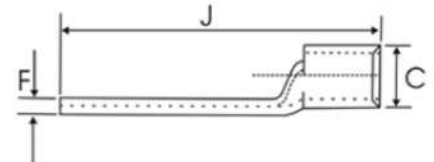
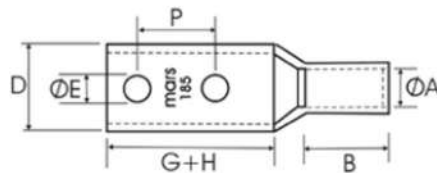

CABLE SIZE (MM ²)	STUD SIZE (MM)	DIMENSIONS (MM)									MARS CAT NO.
		ØE	ØA	C	D	F	B	9	G+H	J	
70	12	13	11.2	14.7	21	3.5	18	45	75	105	MEP 70-12
95	12	13	13.5	17.4	25	3.9	20	45	75	111	MEP 95-12
120	12	13	15	19.4	28	4.4	22	45	75	115	MEP 120-12
150	12	13	16.5	21.2	30	4.7	26	45	75	120	MEP 150-12
185	12	13	18.5	23.5	34	5.0	32	45	75	127	MEP 185-12
240	12	13	21	26.5	38	5.5	38	45	75	134	MEP 240-12
300	12	13	23.5	30	43	6.5	42	45	75	142	MEP 300-12

Note:

- » Stud Size and center are standard. Other Sizes and centers can be provided if required.
- » The Barrel size are standard. Other barrel size can be provided if required.

Copper Compression Four Hole Cable Lugs

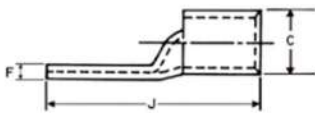
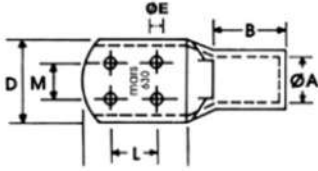

Copper Compression Four Hole Transformer Terminals

● MATERIAL :

COPPER to BS 1977

● COPPER CONDUCTIVITY :

99.25% IACS (International Annealed Copper standard)

● FINISH :

Electro-Tin plated to prevent corrosion and improve conductivity.

● SALIENT FEATURES :

Barrel Entrance Chamfered to facilitate cable insertion smoothly and easily.

Inspection Window to ensure full conductor insertion.

Lugs are fully annealed for secured crimping.

CABLE SIZE (MM ²)	STUD SIZE (MM)	DIMENSIONS (MM)										MARS CAT NO.
		ØE	ØA	C	D	F	B	N	M	L	J	
300	4 x 8	8.5	23.5	30	58	6.5	42	52	34.9	25.4	109	MT 300-8
	4 x 10	10.5										MT 300-10
400	4 x 8	8.5	26.8	34.8	58	8	44	52	34.9	25.4	114	MT 400-8
	4 x 10	10.5										MT 400-10
500	4 x 8	8.5	30	39	56	9	48	56	34.9	25.4	124	MT 500-8
	4 x 10	10.5										MT 500-10
630	4 x 8	8.5	35	45	65	10	56	66	34.9	25.4	144	MT 630-8
	4 x 10	10.5										MT 630-10

Note:

» The Stud Size and center are standard. Other sizes and centers can be provided if required.

Copper Compression Long Barrel Connector

Long Barrel In-Line Connectors

Long Barrel connectors permit additional crimp for added mechanical strength and dimple at The Center of Connector acts as a stopper for the conductors this assures that the conductors are inserted fully and equally before crimping. Internal end chamfer allows easy conductor crimping. Internal end prevents sharp edge contact with conductor.

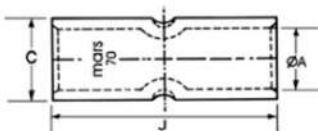

● MATERIAL :

COPPER to BS 1977

● COPPER CONDUCTIVITY :

99.25% IACS (International Annealed Copper standard)

● FINISH :

Electro-Tin plated to prevent corrosion and improve conductivity.

● SALIENT FEATURES :

Barrel Entrance Chamfered at both ends to facilitate cable insertion smoothly and easily.

Center stop assures proper conductor positioning before crimping as well as acts as cable stopper.

Connectors are fully annealed for secured crimping.

CABLE SIZE MM ²	DIMENSIONS MM			MARS CAT NO.
	ØA	C	J	
1.5	1.8	3.7	22	ML 1.5
2.5	2.4	4	22	ML 2.5
4	3.1	4.8	22	ML 4
6	3.8	5.5	22	ML 6
10	4.5	6.2	22	ML 10
16	5.4	7.1	44	ML 16
25	6.8	8.8	47	ML 25
35	8.2	10.6	47	ML 35
50	9.5	12.4	47	ML 50
70	11.2	14.7	50	ML 70
95	13.5	17.4	54	ML 95
120	15	19.4	65	ML 120
150	16.5	21.2	65	ML 150
185	18.5	23.5	65	ML 185
240	21	26.5	89	ML 240
300	23.5	30	89	ML 300
400	28.5	36.5	90	ML 400
500	30	39	115	ML 500
550	31.7	41.5	115	ML 550
630	35	45	115	ML 630
800	39	50.6	230	ML 800
1000	43	56.2	230	ML 1000

Copper Compression Short Connector

Short Barrel In-Line Connectors

CABLE SIZE MM ²	DIMENSIONS MM			MARS CAT NO.
	ØA	C	J	
1.5	1.8	3.7	15	MS 1.5
2.5	2.4	4	15	MS 2.5
4	3.1	4.8	15	MS 4
6	3.8	5.5	15	MS 6
10	4.5	6.2	20	MS 10
16	5.4	7.1	20	MS 16
25	6.8	8.8	32	MS 25
35	8.2	10.6	36	MS 35
50	9.5	12.4	40	MS 50
70	11.2	14.7	45	MS 70
95	13.5	17.4	45	MS 95
120	15	19.4	45	MS 120
150	16.5	21.2	55	MS 150
185	18.5	23.5	60	MS 185
240	21	26.5	80	MS 240
300	23.5	30	85	MS 300
400	28.5	36.5	85	MS 400
500	30	39	100	MS 500
550	31.7	41.5	110	MS 550
630	35	45	110	MS 630
800	39	50.6	150	MS 800
1000	43	56.2	170	MS 1000

Copper Compression Butt Connector

Butt Connectors

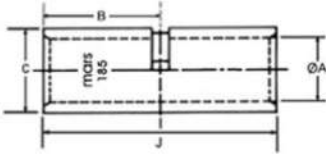

● MATERIAL :

COPPER to BS 1977

● COPPER CONDUCTIVITY :

99.25% IACS (International Annealed Copper standard)

● FINISH :

Electro-Tin plated to prevent corrosion and improve conductivity.

● SALIENT FEATURES :

Barrel Entrance chamfered at both ends to facilitate cable insertion smoothly and easily.

Center stop has an V cut inspection hole which assures proper conductor position before crimping as well acts as cable stopper.

Connectors are fully annealed for secured crimping.

CABLE SIZE MM ²	DIMENSIONS MM			MARS CAT NO.
	ØA	B	J	
1.5	1.8	6	15	MB 1.5
2.5	2.4	7.5	15	MB 2.5
4	3.1	7.5	15	MB 4
6	3.8	7.5	15	MB 6
10	4.5	10	20	MB 10
16	5.4	10	20	MB 16
25	6.8	16	32	MB 25
35	8.2	18	36	MB 35
50	9.5	20	40	MB 50
70	11.2	22.5	45	MB 70
95	13.5	22.5	45	MB 95
120	15	22.5	45	MB 120
150	16.5	27.5	55	MB 150
185	18.5	30	60	MB 185
240	21	40	80	MB 240
300	23.5	42.5	85	MB 300
400	28.5	42.5	85	MB 400
500	30	50	100	MB 500
550	31.7	55	110	MB 550
630	35	55	110	MB 630
800	39	75	150	MB 800
1000	43	85	170	MB 1000

Note:

- » Exhibited are standard length of connectors and can be provided in different length.
- » Bell Mouthed entry available on request from 10 mm² to 400 mm².

Copper Compression Parallel Connector

Parallel Connectors



● MATERIAL :

COPPER to BS 1977

● COPPER CONDUCTIVITY :

99.25% IACS (International Annealed Copper standard)

● FINISH :

Electro-Tin plated to prevent corrosion and improve conductivity.

● SALIENT FEATURES :

Barrel Entrance Chamfered to facilitate cable insertion smoothly and easily.

Connectors are fully annealed for secured crimping.

CABLE SIZE MM ²	DIMENSIONS MM			MARS CAT NO.
	ØA	C	J	
1.5	1.8	3.7	7	MP 1.5
2.5	2.4	4	7	MP 2.5
4	3.1	4.8	7	MP 4
6	3.8	5.5	7	MP 6
10	4.5	6.2	9	MP 10
16	5.4	7.1	10	MP 16
25	6.8	8.8	11	MP 25
35	8.2	10.6	12	MP 35
50	9.5	12.4	16	MP 50
70	11.2	14.7	18	MP 70
95	13.5	17.4	20	MP 95
120	15	19.4	23	MP 120

Note:

- » Exhibited are standard length of connectors and can be provided in different length.